

ITEM NO.	PART NUMBER	DESCRIPTION	QTY.
1	2-098	MOUNTING KIT FOR MIX/EDGE SERIES	1
	30042	WALL MOUNTING PLATE	1
	92043	SCREW, FLAT HD #10 SIZE W/ #2 PHIL DRIVE, 2"L	2
	92046	ANCHOR SCREW 3/8" HOLE, TOGGLER AF10	2
2	3-367/00	ASSY. GARMENT HOOK, STRIA SERIES	1
	10941/00	ESCUTCHEON, ACCESORIES EDGE SERIES	1
	11228/00	POST, GARMENT HOOK 291 STRIA SERIES	1
	92094	SCREW, PAN HD 8-32 X 1.5"L	1
	92005	SET SCREW, CUP PT 6-32UNC THREAD 3/16"L	1
	11229/00	FINIAL END, GARMENT HOOK 291 STRIA SERIES	1

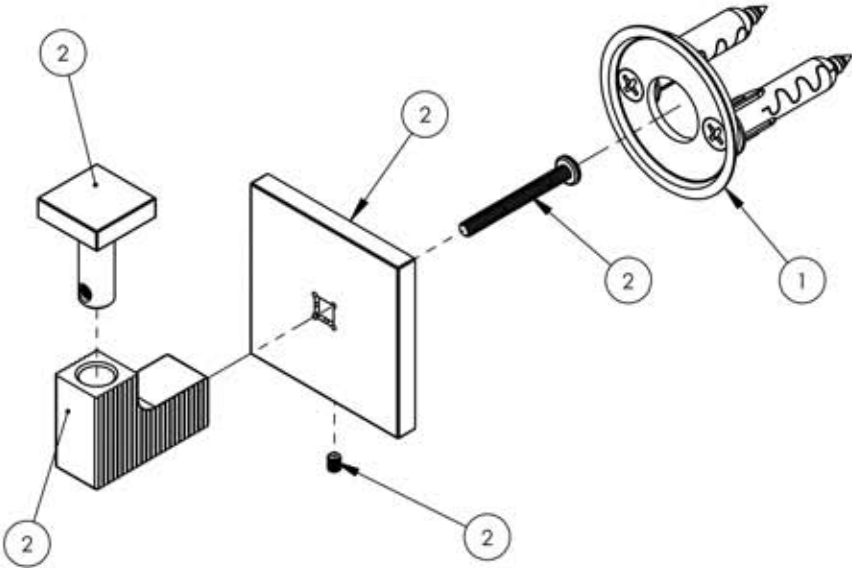

ZONE	REV.	DESCRIPTION	DATE	APPROVED
------	------	-------------	------	----------

REVISIONS
-----------

1261 LOGAN AVENUE COSTA MESA, CALIFORNIA 92626 PHONE: 714.361.4800 FAX: 714.617.3120	<b>PHYLIRICH®</b> Defining Luxury Since 1959	<b>PROPRIETARY AND CONFIDENTIAL</b> THE INFORMATION CONTAINED IN THIS DRAWING IS THE SOLE PROPERTY OF RSS MANUFACTURING. ANY REPRODUCTION IN PART OR AS A WHOLE WITHOUT THE WRITTEN PERMISSION OF RSS MANUFACTURING IS PROHIBITED.
---	---	---

-	-	INTERPRET GEOMETRIC DIMENSIONING & TOLERANCING IN ACCORDANCE WITH ASME Y14.5-2009 & ASME Y14.41-2003 STANDARDS. UNLESS OTHERWISE SPECIFIED, DIMENSIONS ARE IN INCHES. TOLERANCES ARE:			ROBE HOOK, STRIA SERIES		
NEXT ASSY	USED ON	FRACTIONS ± 1/64	DECIMALS X.X: ± .1 X.XX: ± .01 X.XXX: ± .005	ANGULAR ± .5°	SIZE <b>A</b>	ASM/PRT NO. 291-76/00	REV -
MATERIAL	APPLICATION	NAME	DATE	DRAWN	LLO	12/23/2014	
FINISH	DO NOT SCALE DRAWING	CHECKED	GRE	SCALE: 1:2	WEIGHT: lbs.	SHEET 1 OF 2	

5

4

3

2

1